

Empotrar Recessed

Star 66

ST66

Perfil para pladur, frontal.
Fabricado con aluminio extrusionado y anodizado.
Diseñado como disipador de tiras de LED.

Plasterboard profile, front.
Made of extruded and anodized aluminium.
Designed to dissipate LED strips.



Características técnicas

Technical data

Potencia disipada Power dissipation	Máx. 20W/m
Aleación de aluminio Aluminium alloy	AL6060
Longitud Length	2m ⁽¹⁾
IP	20
Acabado Finish	Anodizado Anodized / Pintado Painted

⁽¹⁾ Otras medidas disponibles. Máximo 6m. Other sizes available. Maximum 6m.

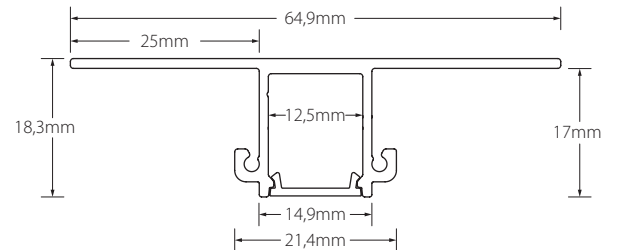

2101751
Mate
Medium frosted
40°
-30% lm

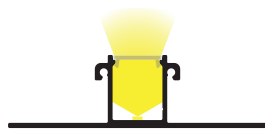

220630007
Tapa final
End cap



220631007
Tapa final, con taladro
End cap with cable hole

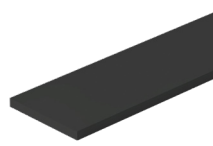

25300102202
Pletina plástico 20x2mm
Plastic plate 20x2mm



Empotrar Recessed

Star 66

Referencia Reference	Descripción Description	Acabado Finish	Color Color
ST66-A	Perfil empotrado aluminio Aluminium recessed profile	Anodizado Anodized	● Plata mate Matt silver
ST66-B	Perfil empotrado aluminio Aluminium recessed profile	Pintado Painted	○ Blanco White
ST66-N	Perfil empotrado aluminio Aluminium recessed profile	Anodizado Anodized	● Negro Black

Accesorios Accessories

Referencia Reference	Descripción Description	Acabado / Color Finish / Color
2101751	Difusor para ST66 Diffuser to ST66	Mate Medium
220630007	Tapa final aluminio Aluminium end cap	Plata mate Matt silver
220631007	Tapa final aluminio con taladro Aluminium end cap with cable hole	
220630001	Tapa final aluminio Aluminium end cap	Blanco White
220631001	Tapa final aluminio con taladro Aluminium end cap with cable hole	
220630002	Tapa final aluminio Aluminium end cap	Negro Black
220631002	Tapa final aluminio con taladro Aluminium end cap with cable hole	
25300102202	Pletina plástico reciclado Recycled plastic plate	Negro Black

Montaje Assembly

Pladur 15mm
15mm plasterboard

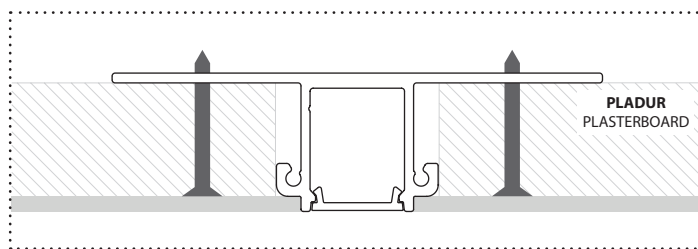

Pladur 13mm
13mm plasterboard

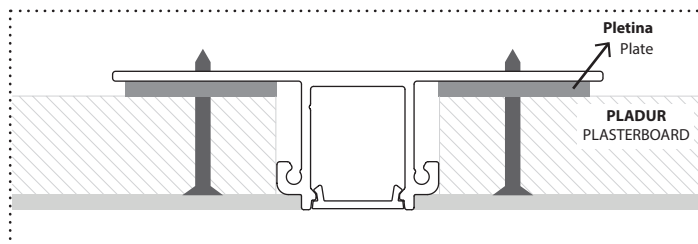

Empotrar Recessed

Star 66



Advertencias Warnings

- Si la superficie donde va colocada la tira de LED tiene residuos, asegúrese de limpiarla hasta que quede libre de ellos.
- No utilizar este perfil para LEDs superiores a la potencia indicada, ya que no se podría garantizar la vida útil del LED.
- No utilice cola o silicona para fijar el perfil sin antes asegurar que la posición funcional es la correcta.
- If the surface where the LED strip is located has debris, be sure to clean it until it is free of them.
- Not use this profile to LED above the indicated power because it could not guarantee the life of the LED.
- Do not use glue or silicone to set the profile if before ensuring that the functional position is correct.

